



COMMERCIAL FABRICATION DIVISION

[www.herculesIndustries.com](http://www.herculesIndustries.com)

1310 W. Evans Ave. Denver, Colorado 80223

Tel. 303 937-1000 Fax. 303 937-0903

Toll Free. 1 800 356-5350

## Straight Spin Ins

ITEM	D	L
5004	4	4.875
5005	5	4.875
5006	6	4.875
5007	7	4.875
5008	8	4.875
5009	9	4.875
5010	10	4.875
5012	12	4.875
5014	14	4.875
5016	16	4.875
5018	18	4.875
5020	20	4.875

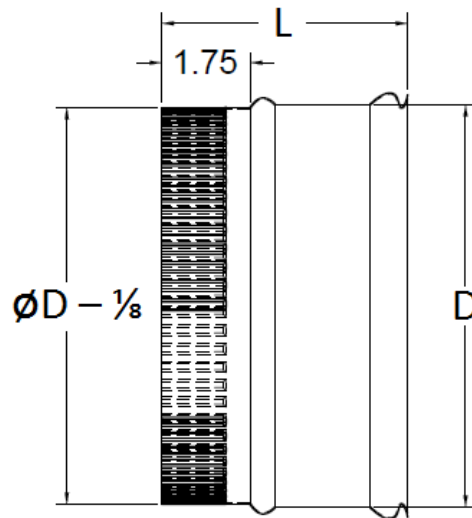

\* all dimensions in inches  $\pm$  0.125

- Spin Ins constructed of **26Ga. Galvanized Steel ASTM-A653-00**
- SMACNA Standards
- All gauges and reinforcements are in compliance with 2005 SMACNA standards for duct fabrication





**Hercules**  
**INDUSTRIES**

COMMERCIAL FABRICATION DIVISION

[www.herculesIndustries.com](http://www.herculesIndustries.com)

1310 W. Evans Ave. Denver, Colorado 80223

Tel. 303 937-1000 Fax. 303 937-0903

Toll Free. 1 800 356-5350

# Straight Spin Ins with Damper

ITEM	D	L	E
6004	4	4.875	2.625
6005	5	4.875	2.625
6006	6	4.875	2.625
6007	7	6.25	3.375
6008	8	7.5	3.875
6009	9	8.125	4.375
6010	10	8.875	4.75
6012	12	10.125	5.375
6014	14	11.5	6.25
6016	16	12.875	6.875
6018	18	14.25	7.625
6020	20	15.625	8.375

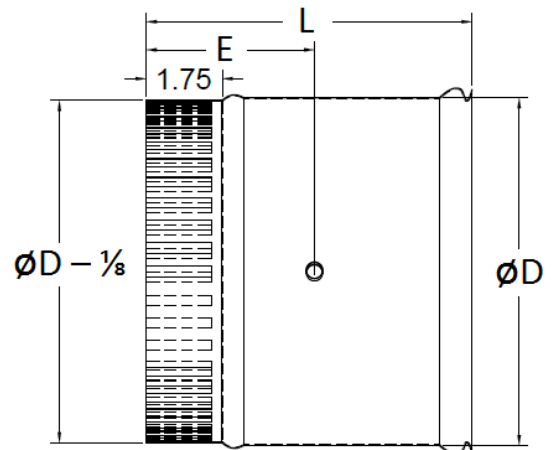

\* all dimensions in inches  $\pm 0.125$

- Spin Ins constructed of **26Ga.** Galvanized Steel **ASTM-A653-00**
- SMACNA Standards
- All gauges and reinforcements are in compliance with 2005 SMACNA standards for duct fabrication





**Hercules**  
**INDUSTRIES**

COMMERCIAL FABRICATION DIVISION

[www.herculesIndustries.com](http://www.herculesIndustries.com)

1310 W. Evans Ave. Denver, Colorado 80223

Tel. 303 937-1000 Fax. 303 937-0903

Toll Free. 1 800 356-5350

## Conical Spin Ins

ITEM	A	B	L
8504	4	6	6.375
8505	5	8	6.375
8506	6	8	6.375
8507	7	10	6.375
8508	8	10	6.375
8509	9	12	6.375
8510	10	12	6.375
8512	12	14	6.375
8514	14	16	6.375
8516	16	18	6.375
8518	18	20	6.375
8520	20	22	6.375

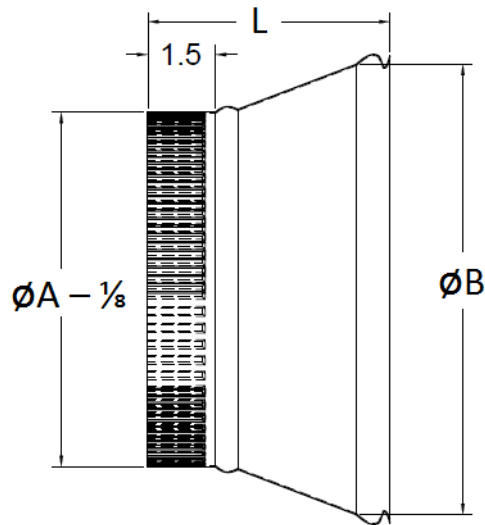

\* all dimensions in inches  $\pm 0.125$

- Spin Ins constructed of **26Ga.** Galvanized Steel **ASTM-A653-00**
- SMACNA Standards
- All gauges and reinforcements are in compliance with 2005 SMACNA standards for duct fabrication





**Hercules**  
**INDUSTRIES**

COMMERCIAL FABRICATION DIVISION

[www.herculesIndustries.com](http://www.herculesIndustries.com)

1310 W. Evans Ave. Denver, Colorado 80223

Tel. 303 937-1000 Fax. 303 937-0903

Toll Free. 1 800 356-5350

# Conical Spin Ins with Damper

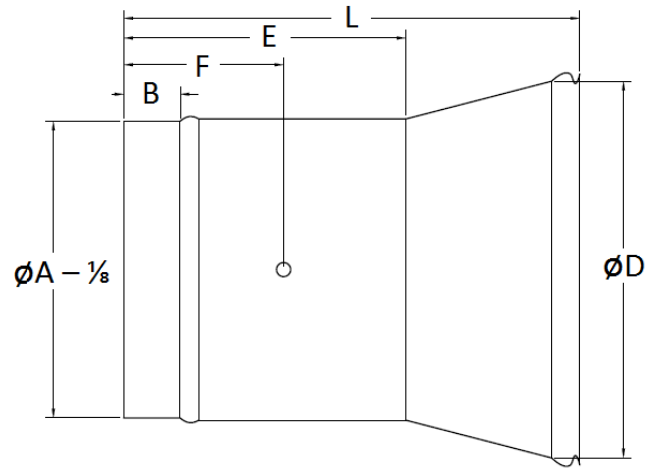

ITEM	A	B	D	L	E	F
9004	4	1	6	9.5	5	2.75
9005	5	1	8	9.5	5	2.75
9006	6	1	8	9.5	5	2.75
9007	7	1.5	10	12.125	7.5	4.25
9008	8	1.5	10	12.125	7.5	4.25
9009	9	1.75	12	13.125	8.5	4.75
9010	10	1.75	12	14.125	9.5	5
9012	12	1.75	14	16.125	11.5	6
9014	14	1.75	16	16.125	11.5	6
9016	16	1.75	18	16.125	11.5	6
9018	18	1.75	20	16.125	11.5	6
9020	20	1.75	22	16.125	11.5	6

\* all dimensions in inches  $\pm 0.125$



- Spin Ins constructed of **26Ga.** Galvanized Steel **ASTM-A653-00**
- SMACNA Standards
- All gauges and reinforcements are in compliance with 2005 SMACNA standards for duct fabrication

